



Ceiling System

**Thermal and Acoustic Insulation in
Gypsum Board Suspended Ceilings**



**High Thermal
Insulation**



**Sound
Insulation**



**Quick and Easy
Installation**



Versatile
Ideal for all environments -
residential / commercial / public

Ceiling System

Thermal and Acoustic Insulation in Gypsum Board Suspended Ceilings

Combining aesthetics with functionality, gypsum board suspended ceiling systems have become a popular choice in modern interior design. These systems not only provide a clean and stylish appearance but also offer effective solutions for thermal and acoustic insulation.

To maximize sound insulation performance in suspended ceilings, Felt Vibe Thermal and Acoustic Insulation Felts are an ideal solution. Thanks to their high-density and fibrous structure, these felts effectively absorb sound waves, significantly reducing noise and vibrations from upper floors.

Sound insulation plays a crucial role in combating the increasing problem of noise pollution, especially in urban environments. The multi-layered structure, consisting of insulation materials mounted on gypsum profiles followed by gypsum panels, helps dissipate the energy of sound waves as they pass through. As a result, it creates quieter and more comfortable indoor spaces.

Applications Types

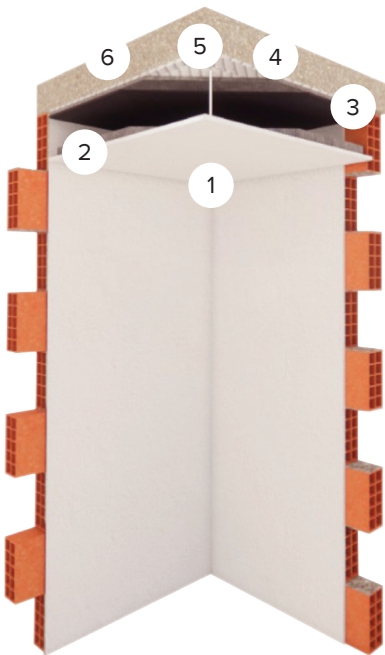

Plaster Suspended Ceiling Insulation

1. Suspended plasterboard ceiling
2. Plasterboard
3. Low-density felt
4. Arketa PET Felt Panel
5. Adhesive mortar bed
6. Existing floor covering

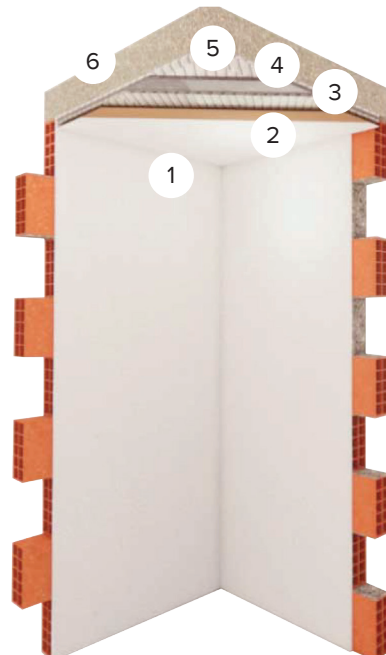

Ceiling Insulation

1. Plasterboard
2. Wall Mesh
3. Adhesive Mortar
4. Arketa Basic PET Felt Panel
5. Adhesive Mortar
6. Existing floor covering



ARKETA-07

Composition	100% PET, 60% recycled content
Thickness & Weight	7mm (±0.5mm) 700 g/m ² (±10%)
Reaction to Fire	ASTM E 84 Class A
Impact Sound Insulation	$\Delta L_w = 27$ dB / TS EN ISO 717-2:2021
Aging Test	5.90% / TS EN 1606- 2013-06
Thermal Resistance	$\lambda = 0.0373$ W/m ² K / ISO 11092-2024

ARKETA-09

Composition	100% PET, 60% recycled content
Thickness & Weight	9mm (±0.5mm) 1100 g/m ² (±10%)
Reaction to Fire	ASTM E 84 Class A
Impact Sound Insulation	$\Delta L_w = 27$ dB / TS EN ISO 717-2:2021
Aging Test	4.20% / TS EN 1606- 2013-06
Thermal Resistance	$\lambda = 0.0373$ W/m ² K / ISO 11092-2024

ARKETA-15

Composition	100% PET, 60% recycled content
Thickness & Weight	15mm (±0.5mm) 1100 g/m ² (±10%)
Reaction to Fire	ASTM E 84 Class A
Impact Sound Insulation	$\Delta L_w = 29$ dB / TS EN ISO 717-2:2021
Aging Test	2.86% / TS EN 1606- 2013-06
Thermal Resistance	$\lambda = 0.0331$ W/m ² K / ISO 11092-2024

ARKETA-20

Composition	100% PET, 60% recycled content
Thickness & Weight	20mm (±0.5mm) 1300 g/m ² (±10%)
Reaction to Fire	ASTM E 84 Class A
Impact Sound Insulation	$\Delta L_w = 30$ dB / TS EN ISO 717-2:2021
Aging Test	2.86% / TS EN 1606- 2013-06
Thermal Resistance	$\lambda = 0.0330$ W/m ² K / ISO 11092-2024



HEAD OFFICE

Savaş Cad. Söğüt Sok. No: 1
34164 Merter, İstanbul, Türkiye
T: +90 212 637 09 89
F: +90 212 637 02 96
info@feltvibe.com

DÜZCE FACTORY

Organize Sanayii Bölgesi 13. Ada
1/4 Parsel Beyköy Belediyesi
81060 Düzce, Türkiye
T: +90 380 553 73 68-69
F: +90 380 553 73 68-69

GEREDE FACTORY

Gerkonsan Organize
Sanayii Bölgesi
14900 Gerede, Bolu, Türkiye
T: +90 374 311 82 57 / 58
F: +90 374 311 66 37

İZMİR BRANCH

MTK Sitesi 747/ 2 Sokak
No:37 6003 ADA, 6003
Altındağ, İzmir, Türkiye
T: +90 232 431 08 17-18
F: +90 232 431 08 19