

ACOUSTIC
FELT

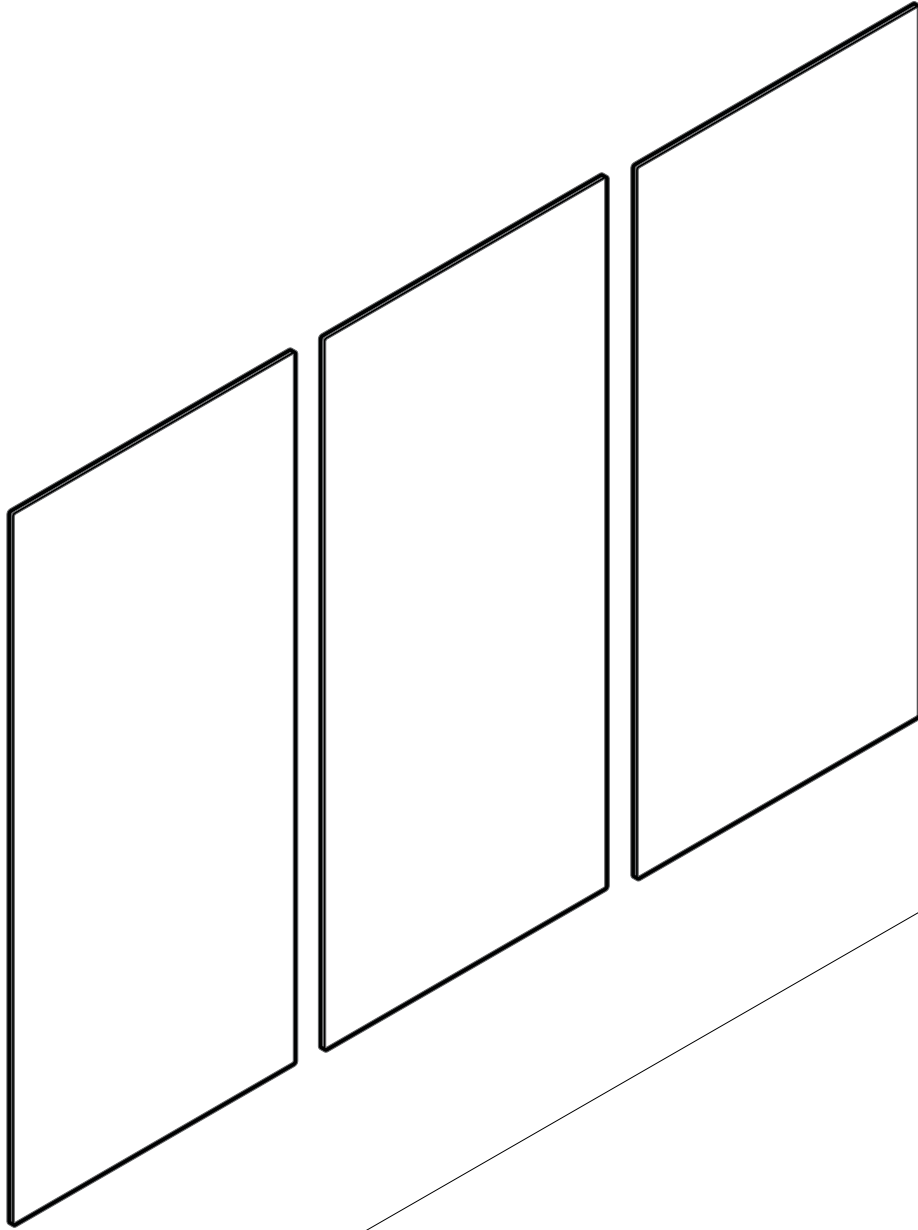

FeltVibe®



Double Acoustic PET Felt Panel

INSTALLATION

DIRECT MOUNT INSTALLATION

Acoustic PET Felt Wall Panels can be attached to walls and ceilings using adhesive.



1. Prepare the surface according to the adhesive manufacturer's instructions. Apply adhesive uniformly to the back of the panel, leaving a 5 cm margin along the edges.
2. Press the panel onto the wall as per the layout plan, applying consistent pressure for the duration specified by the adhesive manufacturer. Wipe away any excess adhesive promptly.

FURRING STRIPS INSTALLATION

To achieve optimal acoustic performance, furring strips can be installed to create an air gap behind the panels. These strips may be made from wood, battens, standoffs, or by cutting additional panel strips.

Standoffs are another option, offering a more decorative installation while enhancing acoustic effectiveness. For best results, we recommend using standoffs with a diameter of at least 3 cm and a depth of up to 5 cm. They should be evenly spaced to adequately support the panel and provide protection against any potential impacts.

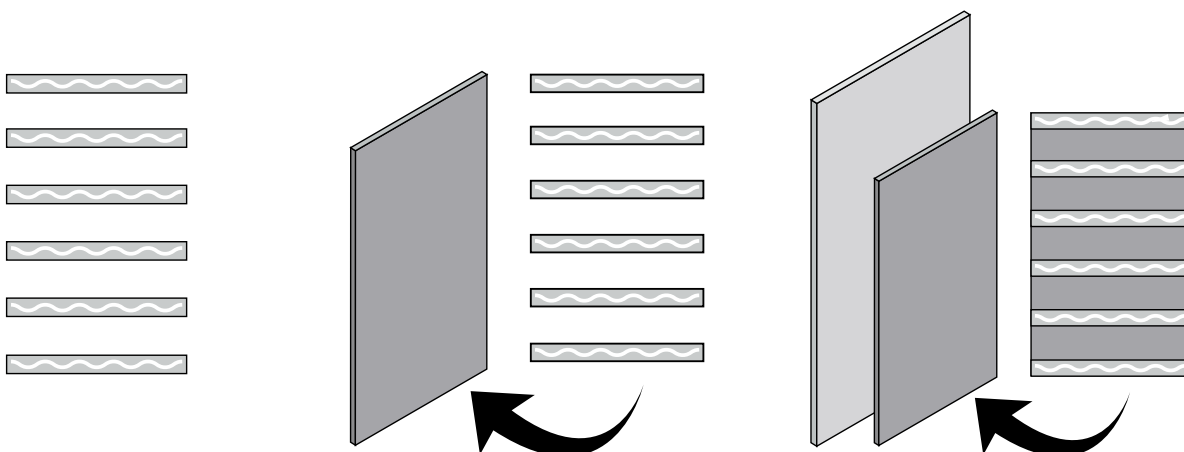

1. Clean and prepare the surface following the adhesive manufacturer's guidelines. Then, apply adhesive evenly onto 8 cm-wide furring strips (recommended width).
2. Position the strips every 15 cm to 45 cm along the panel, depending on the level of potential impact expected.
3. Apply adhesive to the attached furring strips and fix them to the wall according to the layout. Secure the strips following the adhesive instructions, applying consistent pressure for the recommended curing time. Remove any excess adhesive. For a clean finish, edges can be covered with additional panel strips or other suitable materials.

TEMPORARY MOUNTING INSTALLATION

Commercial-grade hook and loop tapes or double-sided tapes with acrylic adhesive may be used for temporary mounting installations. The quality and durability of any temporary installation depend on the condition and texture of the substrate surface, as well as the correct application of the mounting adhesive. The visual guidelines assume a typical flat, smooth, and clean wall surface as a baseline. Please note that Acoustic PET Felt Panels may sustain damage when removed from the wall, depending on the type and amount of temporary adhesive used.

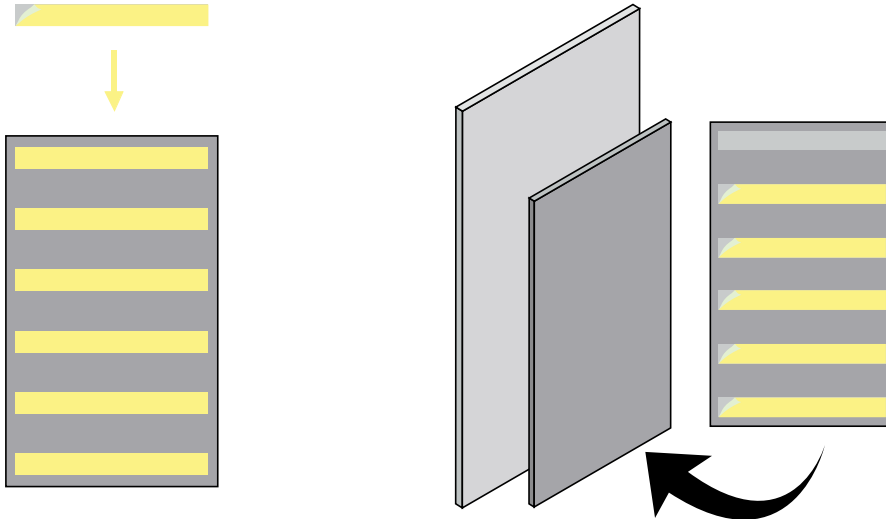

1. Clean and prepare the surface according to the adhesive guidelines. Peel off one side of the temporary adhesive and press it evenly onto the panel. For best results, ensure at least 30% coverage of the panel with adhesive.
2. Remove the backing from the other side of the adhesive and attach the panel to a clean, flat surface following the layout. Apply consistent pressure as recommended by the adhesive manufacturer for the specified duration.

Z-CLIPS INSTALLATION WITH PET PANELS

Z-Clips can be used to mount PET panels by screwing them into both the wall surface and the panels. Be sure to use screws that do not penetrate beyond the panel surface.

1. Clean and prepare the mounting surface. Attach Z-Clips evenly spaced vertically on both the panel and the wall. Position Z-Clips 10 cm to 15 cm from the top of the panel and wall. Use multiple Z-Clips spaced regularly as needed to provide adequate support against potential impact.
2. Full-width Z-Clips are recommended for installing PET panels. To ensure the panels lay flat, support the panel weight primarily from the top full-width Z-Clip. It is advised to install the middle and bottom Z-Clips with a 3 cm gap to allow for panel flex.

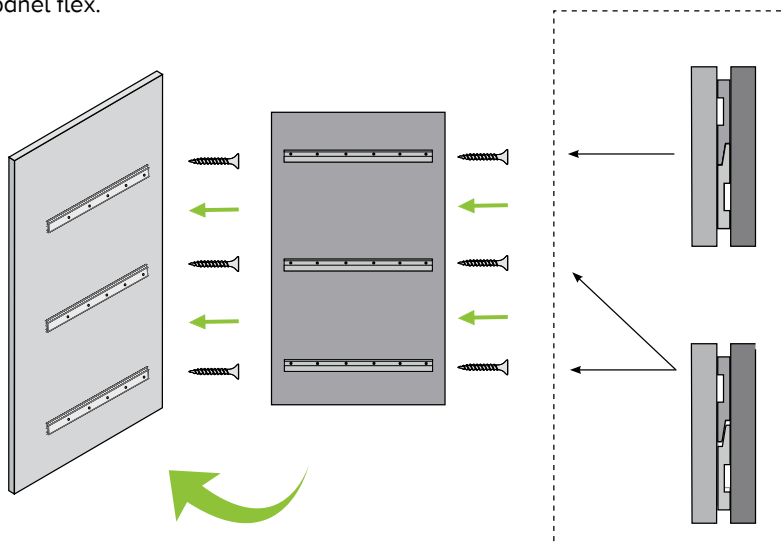

FRAMING SYSTEM INSTALLATION

Acoustic PET Felt Wall Panels are often installed using a variety of architectural aluminum trims. These panels can be mounted on walls or used as freestanding units by framing them with aluminum or other metal or plastic extrusions such as T, J, H, or L trim strips. This method is ideal for Acoustic PET Felt Wall Panels, as it creates lightweight, easy-to-assemble systems without relying on non-recyclable glues or tapes.

Clean and prepare the surface following the adhesive manufacturer's guidelines. Then, proceed with installation according to the manufacturer's instructions. Acoustic PET Felt Wall Panels can be framed using standard J-molding or other trim moldings as specified by the molding instructions. Please note the panel thickness of 11 mm when selecting appropriate moldings or trims.

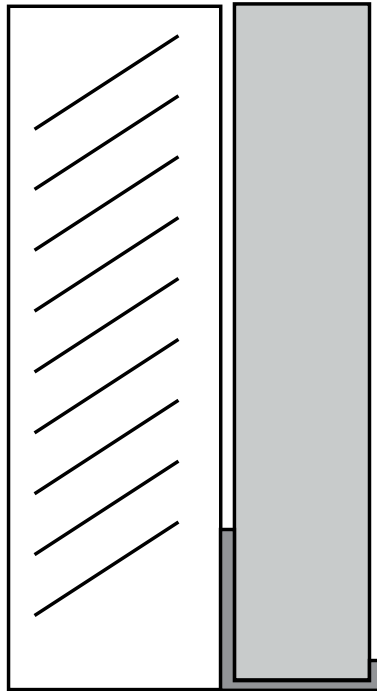

MECHANICAL FASTENERS INSTALLATION

Acoustic PET Felt Wall Panels can be attached to surfaces using mechanical fasteners such as nails, screws, or staples where appropriate. It is important to use fasteners suitable for the substrate. A key advantage of mechanical fasteners is that they can be completely removed without leaving residue, allowing panels to be fully recycled. Avoid overtightening fasteners to prevent denting or pillowing of the panel surface, and do not use self-tapping screws for hanging large panels. Nails or screws should be anchored into battens or other suitable substrates.

1. Clean and prepare the surface. Drill holes at least 15 mm offset from each corner, slightly oversized to allow for thermal expansion and contraction. Ensure the drilled holes have smooth edges.
2. Fasten the panel to the wall according to the layout. Use washers to distribute the load evenly and prevent pull-through. For installations requiring frequent assembly or reassembly, metal inserts are recommended.

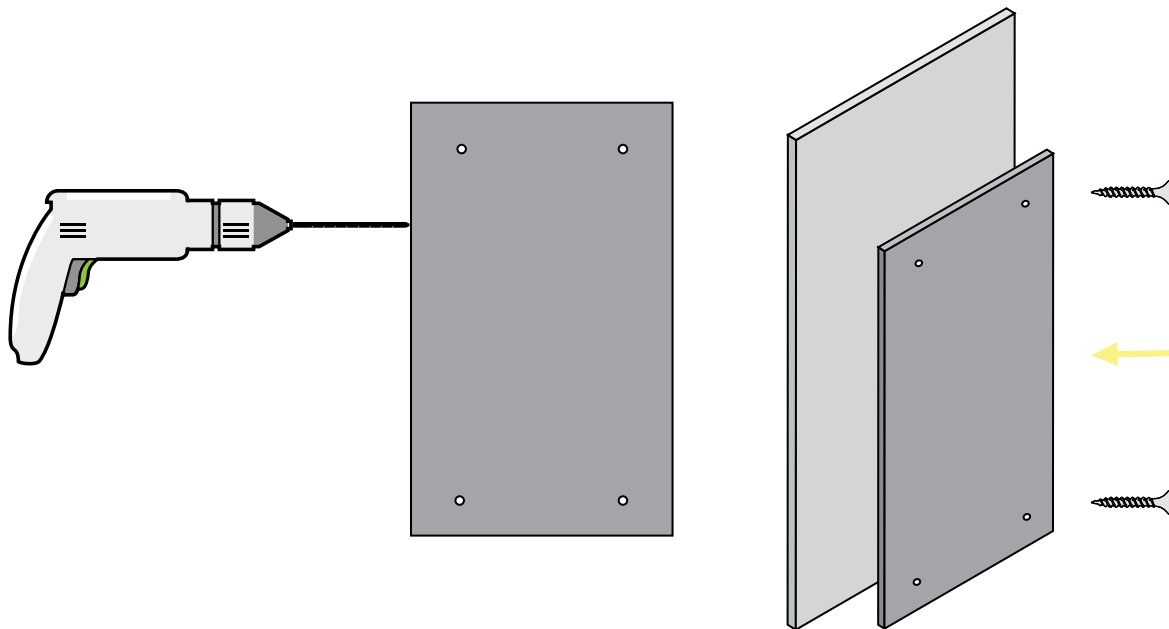



HEAD OFFICE

Savaş Cad. Söğüt Sok. No: 1
34164 Merter, İstanbul, Türkiye
T: +90 212 637 09 89
F: +90 212 637 02 96
info@feltvibe.com

DÜZCE FACTORY

Organize Sanayii Bölgesi 13. Ada
1/4 Parsel Beyköy Belediyesi
81060 Düzce, Türkiye
T: +90 380 553 73 68-69
F: +90 380 553 73 68-69

GEREDE FACTORY

Gerkonsan Organize
Sanayii Bölgesi
14900 Gerede, Bolu, Türkiye
T: +90 374 311 82 57 / 58
F: +90 374 311 66 37

İZMİR BRANCH

MTK Sitesi 747/ 2 Sokak
No:37 6003 ADA, 6003
Altındağ, İzmir, Türkiye
T: +90 232 431 08 17-18
F: +90 232 431 08 19

FOLLOW US



www.feltvibe.com